

DO NOT SCALE

0 10 100  
Millimetres

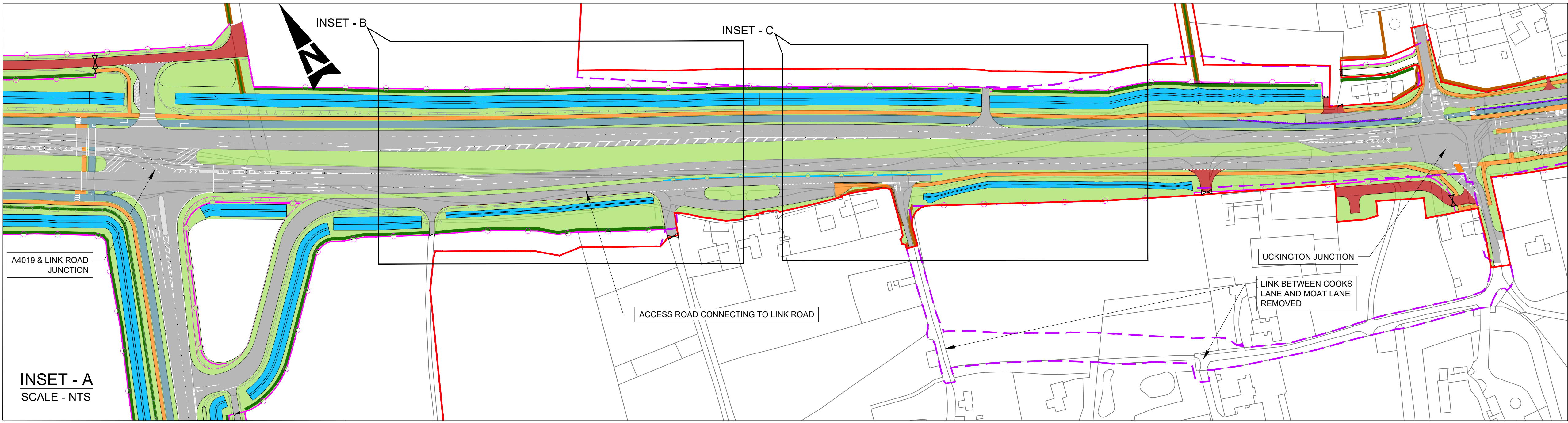
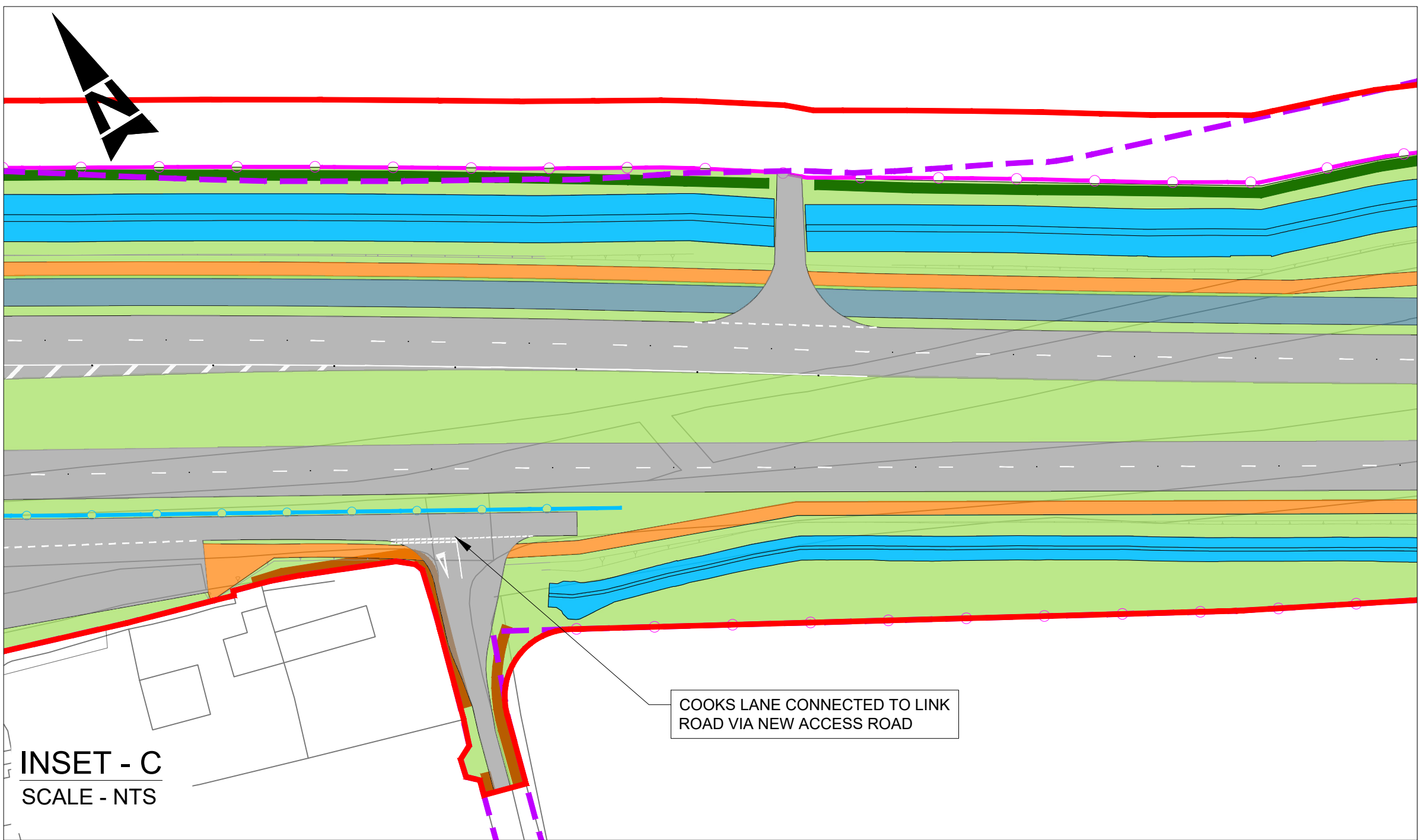
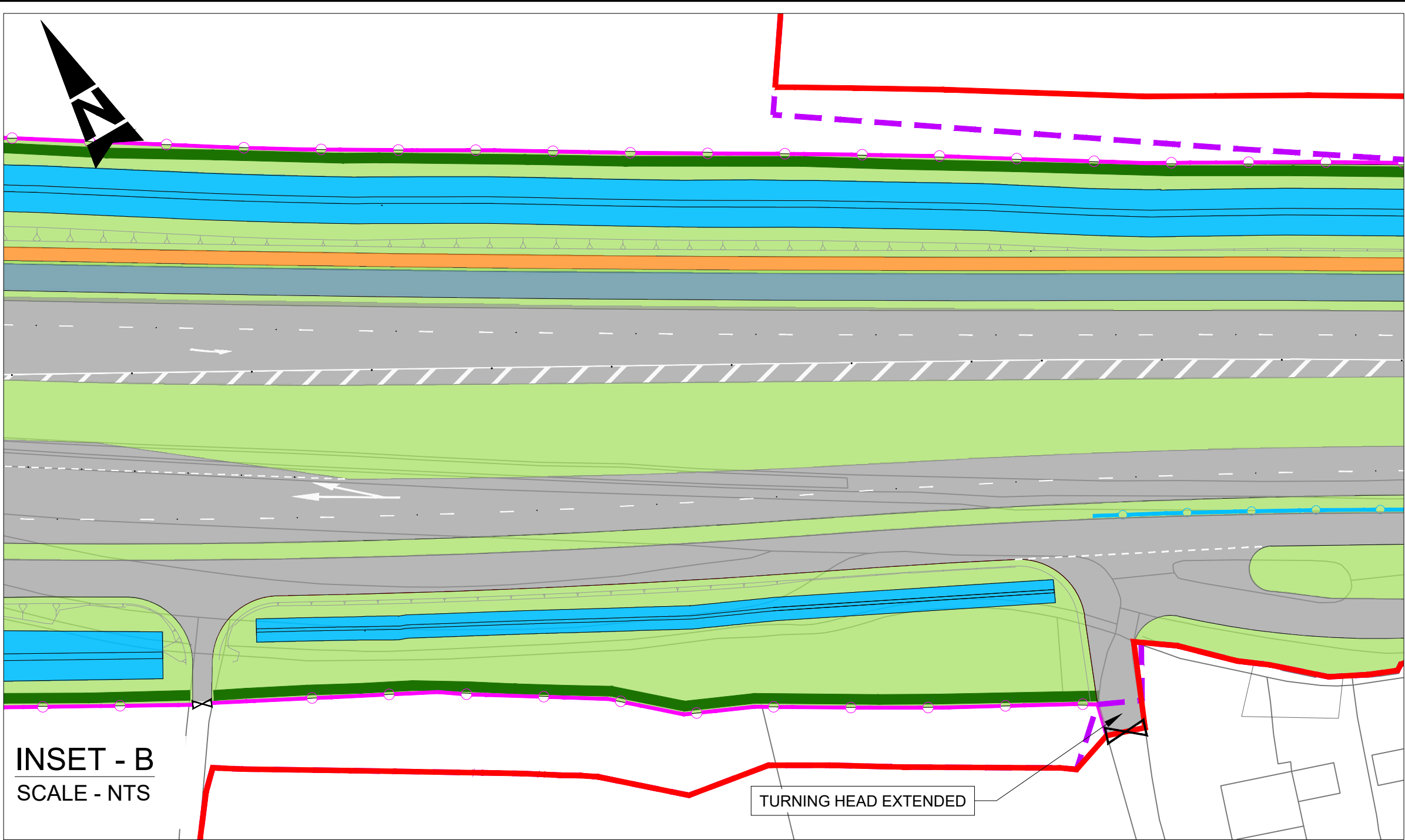
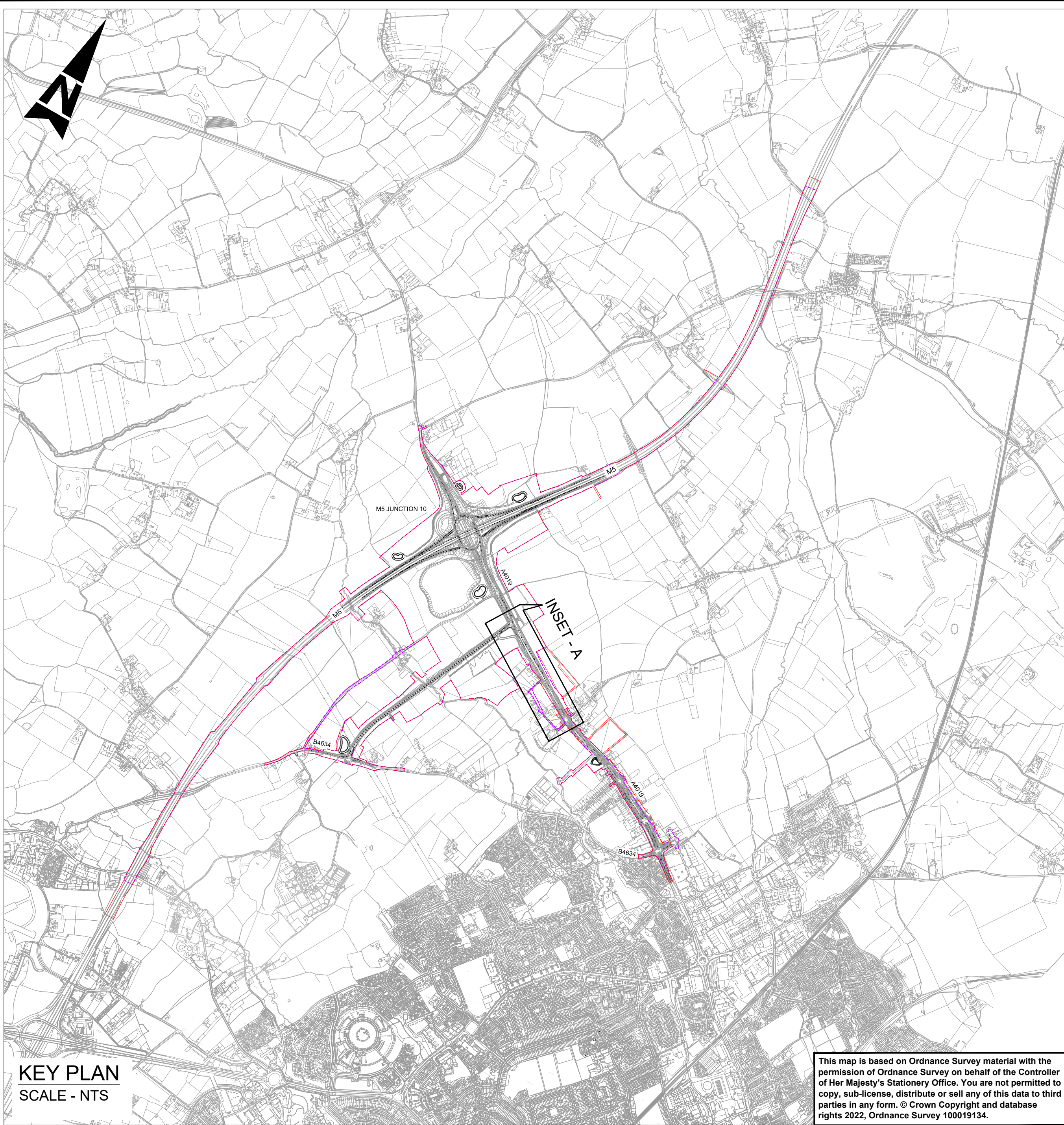

- KEY :**
- INDICATIVE APPLICATION RED LINE BOUNDARY (RLB) FOR TARGETED CONSULTATION
  - INDICATIVE APPLICATION RED LINE BOUNDARY (RLB) FOR PUBLIC CONSULTATION
  - PROPOSED HIGHWAY FENCING
  - PROPOSED REFLECTIVE NOISE BARRIER 2m HIGH
  - PROPOSED GATE
  - PROPOSED OVERBRIDGE
  - PROPOSED UNDERBRIDGE/CULVERT
  - PROPOSED CARRIAGEWAY
  - PROPOSED FOOTWAY
  - PROPOSED CYCLE TRACK
  - PROPOSED SHARED USE PATH
  - PROPOSED ACCESS TRACK
  - PROPOSED ISLAND
  - EXISTING HEDGEROW - TO BE RETAINED
  - EXISTING HEDGEROW - TO BE ENHANCED
  - PROPOSED VEGETATION
  - WATER BODIES/ DITCHES

**SAFETY, HEALTH AND ENVIRONMENTAL INFORMATION**

In addition to the hazards/risks normally associated with the types of work detailed on this drawing, note the following significant residual risks (Reference shall also be made to the design hazard log).

Construction  
Not identified at this stage

Maintenance / Cleaning  
Not identified at this stage

Use  
Not identified at this stage

Decommissioning / Demolition  
Not identified at this stage

Description

Status	Revision	Drawn	Checked	Reviewed	Authorised	Issue Date
--------	----------	-------	---------	----------	------------	------------

Description

Status	Revision	Drawn	Checked	Reviewed	Authorised	Issue Date
--------	----------	-------	---------	----------	------------	------------

Description

Status	Revision	Drawn	Checked	Reviewed	Authorised	Issue Date
--------	----------	-------	---------	----------	------------	------------

Description

Status	Revision	Drawn	Checked	Reviewed	Authorised	Issue Date
--------	----------	-------	---------	----------	------------	------------

Description

Status	Revision	Drawn	Checked	Reviewed	Authorised	Issue Date
--------	----------	-------	---------	----------	------------	------------

Description

**TARGET CONSULTATION**

Status	Revision	Drawn	Checked	Reviewed	Authorised	Issue Date
--------	----------	-------	---------	----------	------------	------------

Drawing Suitability

**APPROVED - PUBLISHED**

**ATKINS**

Member of the SNC-Lavalin Group

5th Floor, Block 5  
Shire Hall  
Bearland  
Gloucester  
GL1 2TH  
Tel : 08000 514514

Copyright © Atkins Limited (2022)

Client

**gloucestershire**  
COUNTY COUNCIL

Project Title

**M5 Junction 10 Improvements Scheme**

Drawing Title

**PROPOSED CHANGES 4 AND 5  
CHANGING COOKS LANE ACCESS  
AND IMPROVED TURNING FACILITIES  
FOR THE FORGE**

Drawing Number

Project

Originator

Volume

Original Size

Scale: NTS

Project Ref. No. 5197035

Sheet: 1 of 1

Rev: C01